



## Service Information

Refrigerator integr.

**ARC 104/1/A+**

8501 104 15030

Last Modification: 07/22/11

Creation Date: 07/09/10

<b>Spare Part List</b>	<b>2</b>
<b>Exploded View</b>	<b>3</b>
<b>Circuit Diagram</b>	<b>4</b>
<b>Technical Data</b>	<b>5</b>
<b>Service Bulletin 4812 711 40347</b>	<b>7</b>
<b>Service Bulletin 4812 711 40338</b>	<b>11</b>
<b>Service Bulletin 4812 711 40310</b>	<b>13</b>

This document is only intended for qualified technicians who are aware of the respective safety regulations.  
Subject to modifications

## Spare Part List

Pos	12NC	Description
0020	4812 462 28994	Cover top
0021	4812 462 28995	Support top cover
0110	4812 462 18316	Foot
0111	4812 462 18315	Foot
0400	4812 417 19493	Hinge upper
0401	4812 417 19494	Hinge lower
0470	4812 417 19523	Hinge
1010	4812 416 10565	Door
1040	4812 416 10566	Door inner
1101	4812 498 18759	Handle Base
1102	4812 498 18761	Handle Cover
1510	4812 418 18749	Bottle shelf
1520	4812 418 20166	Door dairy
1523	4812 418 20174	Separator bottle shelf
1530	4812 418 20169	Door dairy
1531	4812 418 20167	Flap door dairy
1550	4812 418 29978	Icecube tray
1910	4812 468 18393	gasket
2420	4812 418 68451	Crisper
2550	4812 450 88551	Glass shelf
2551	4812 450 88549	Crisper cover Glass
3311	4812 215 38027	Knob thermostat
4020	4812 360 39091	Compressor HVY 57 AA
4021	4812 418 18684	SUPPORT Compressor
4022	4801 311 00091	Tray Compressor
5660	4812 215 38029	THERMOSTAT
5661	4812 215 38028	Cover thermostat
6200	4812 218 38665	Switch door
6510	4812 134 88085	Lamp bulb E14 - 220V
6511	4812 462 29364	Cover lamp
6520	4812 255 18309	Lampholder assembly
7020	4812 526 48259	.ube
7021	4812 526 48261	Tube short
7022	4812 526 48262	Tube long
7400	4812 511 48467	Condenser
7640	4812 480 28126	Filter drier R600a
9100	4812 404 49862	Screw earthing
9998	4801 311 00002	PTC-Unit
9999	4812 360 39093	Klixon

## Exploded View

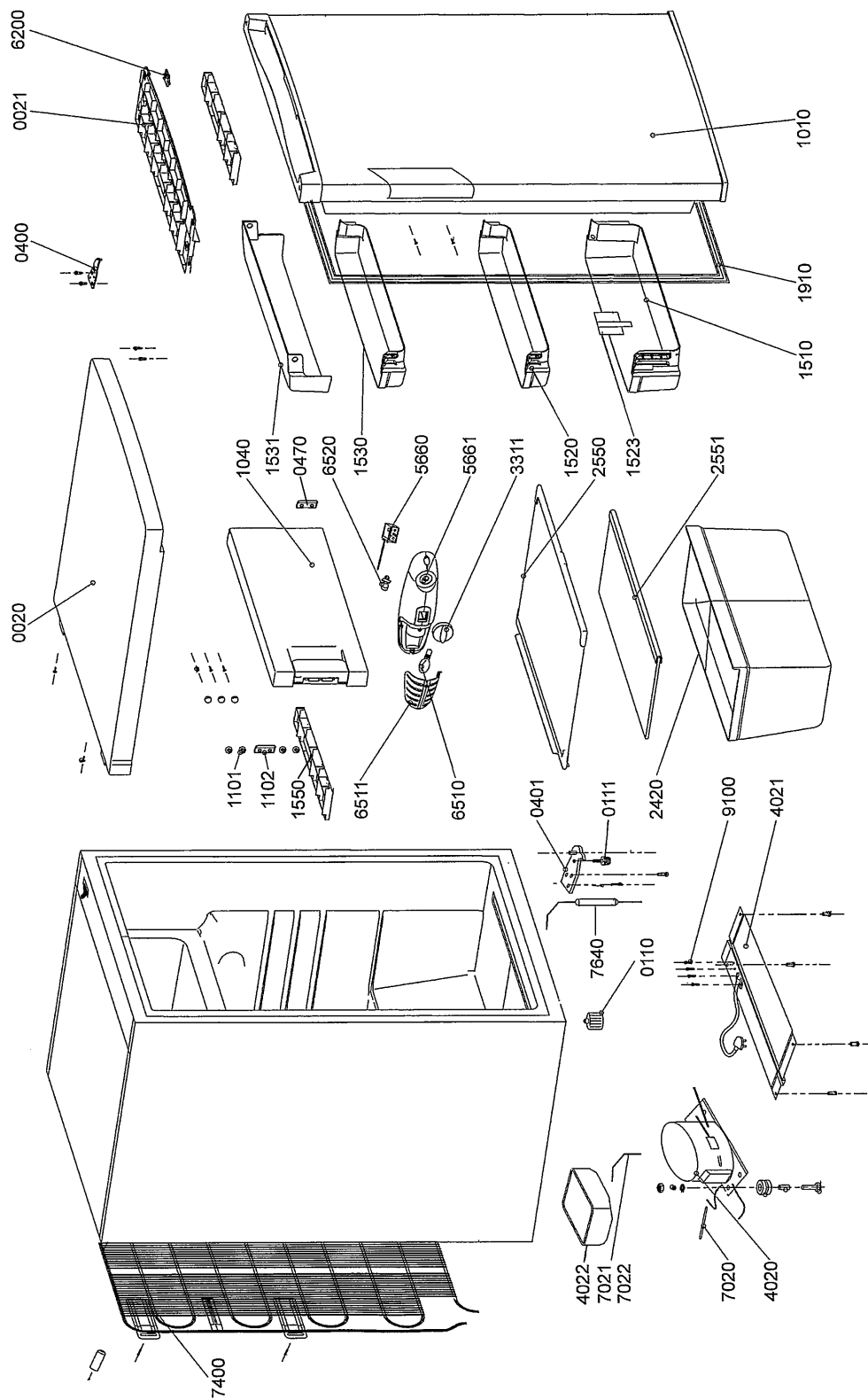

01001959

## Circuit Diagram

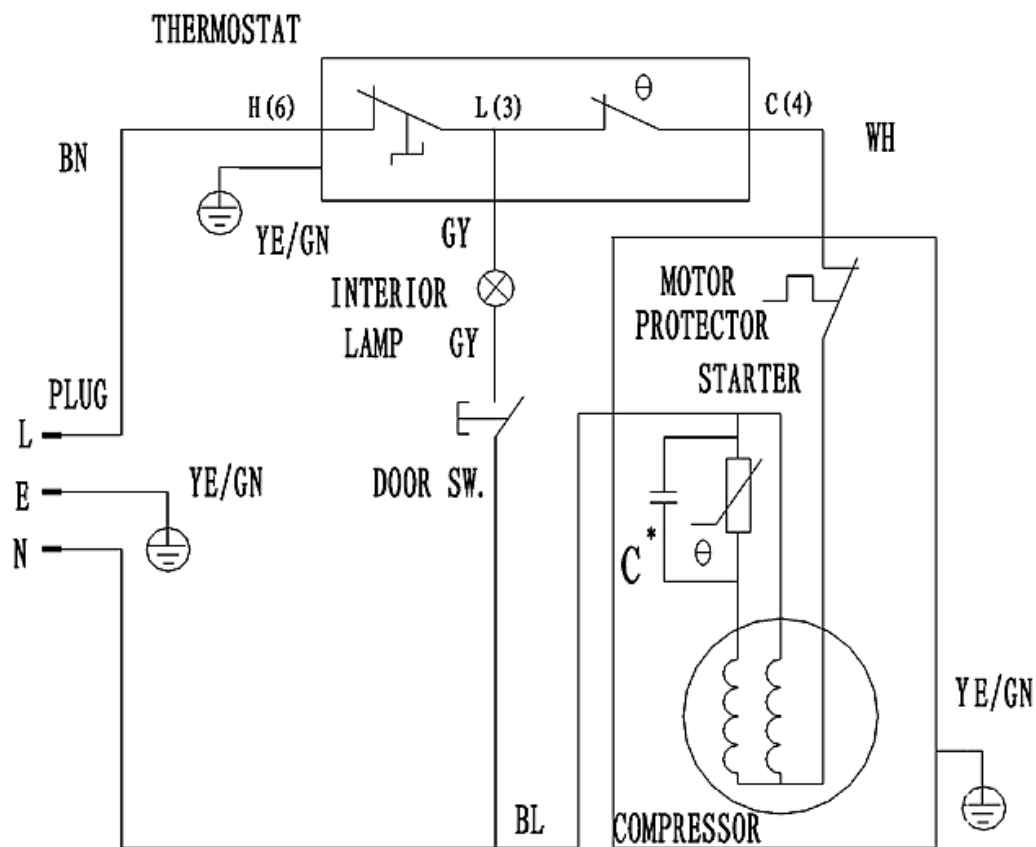

01001792

## Technical Data

### Factory Code

..... DF 1 - 16

### Product dimensions

Height ..... 85.0 cm  
Width ..... 55.0 cm  
Depth ..... 59.0 cm

### Capacity

Total  
Gross ..... 121 l  
net ..... 118 l  
Cooling  
Gross ..... 106 l  
net ..... 103 l  
Freezing  
Gross ..... 15 l  
net ..... 15 l

### Electrical base data

Voltage ..... 220 V - 240 V  
Frequency ..... 50 Hz

### Power Consumption

in 24 hours ..... 0.45 kWh

### Freezing capacity

in 24 hours ..... 2 kg

### Compressor

Type ..... HVY 57 AA  
Capacity(CECOMAF) ..... 88 W

### Refrigerant

Type ..... R 600 a  
Quantity ..... 20 g

**Thermostat switching value**

Switch on temperature

MIN ..... + 5.0 °C

MAX ..... + 5.0 °C

Switch off temperature

MIN ..... - 16.0 °C

MAX ..... - 34.0 °C

## Service Bulletin 4812 711 40347

**AUTHOR:** Robert Zimmermann

**Last Update:** 03/25/11

**VERSION:** 1.0

**TITLE:** Unsticking push-in door gaskets.

**SUBJECT:** In some cases it can happen, that the customer claims loosen door gaskets.

### REMEDIAL ACTION

In case of loosen or unsticking push-in door gaskets, the technician can solve the problem by using a double adhesive tape from Tesa (15mm) with the order number 4812 291 08122. The estimated availability date in SPC is week 24/2010. See below the repair instruction.

Repair Instruction for not sticking “push-in” gaskets:



Step 1:

Pull out the gasket from the door and place the gasket with the anker body side towards to the top on a base.

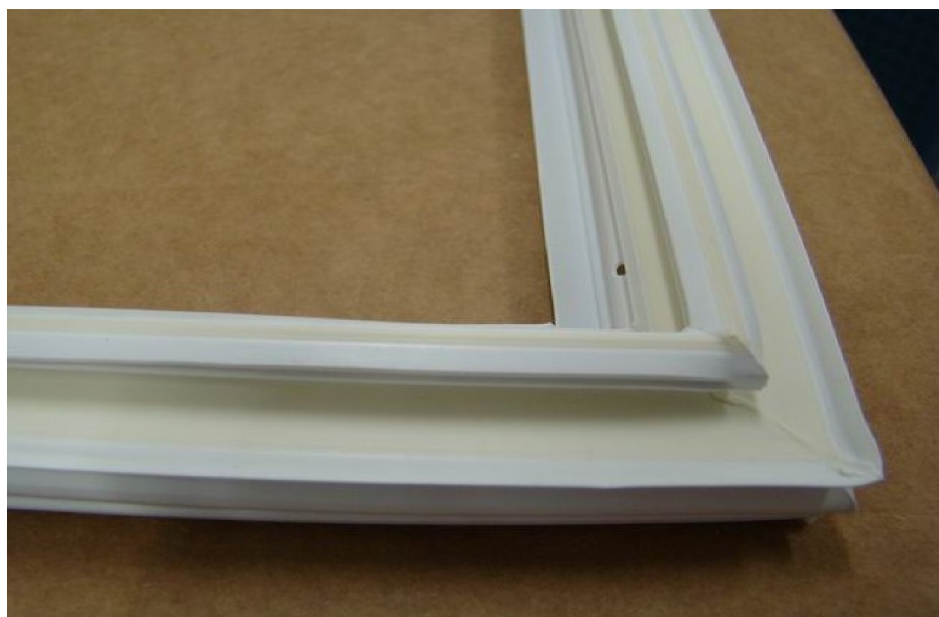



Step 2: Paste up the double adhesive tape on the anker body as shown below.

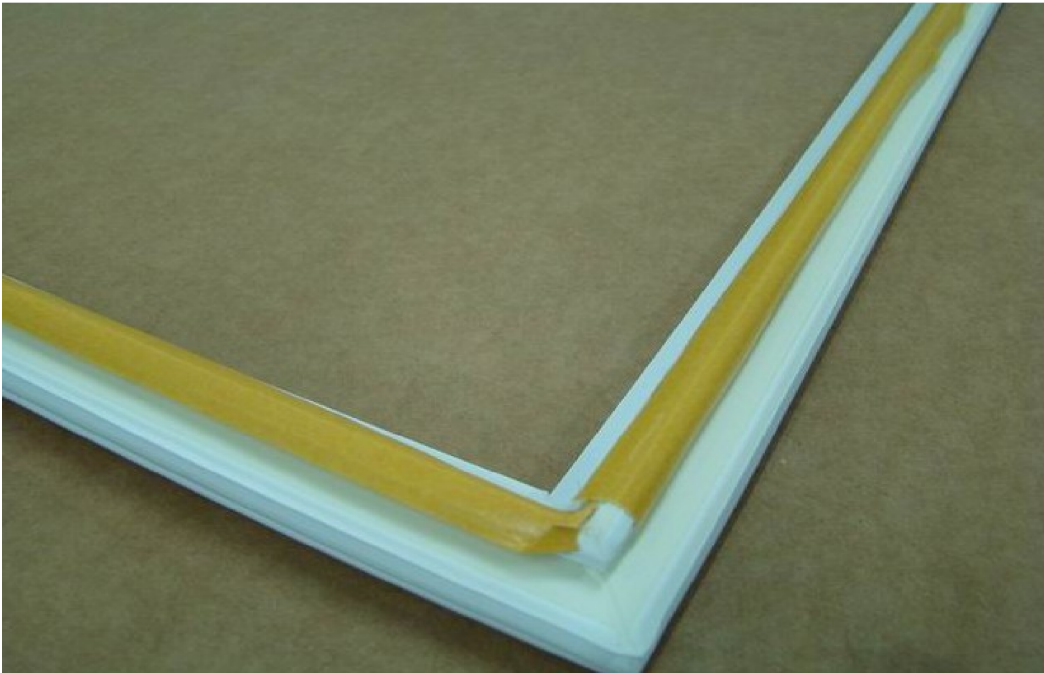

Step 3: Remove the second protection film from the adhesive tape.

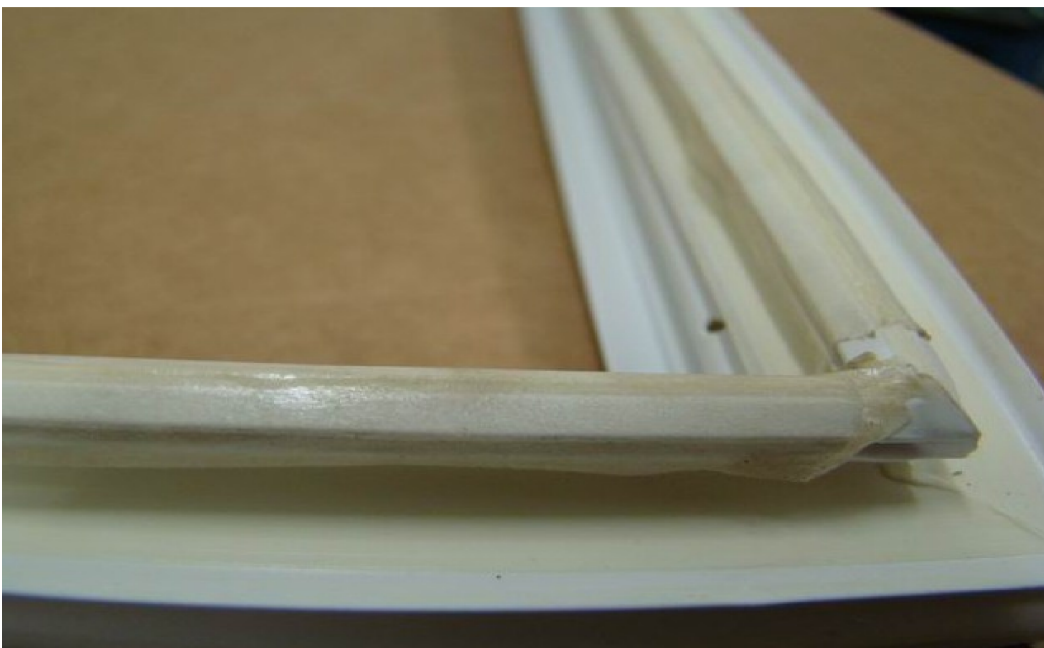

Step 4: Press in the gasket to the gasket channel at the door.  
Start always from the corner side.

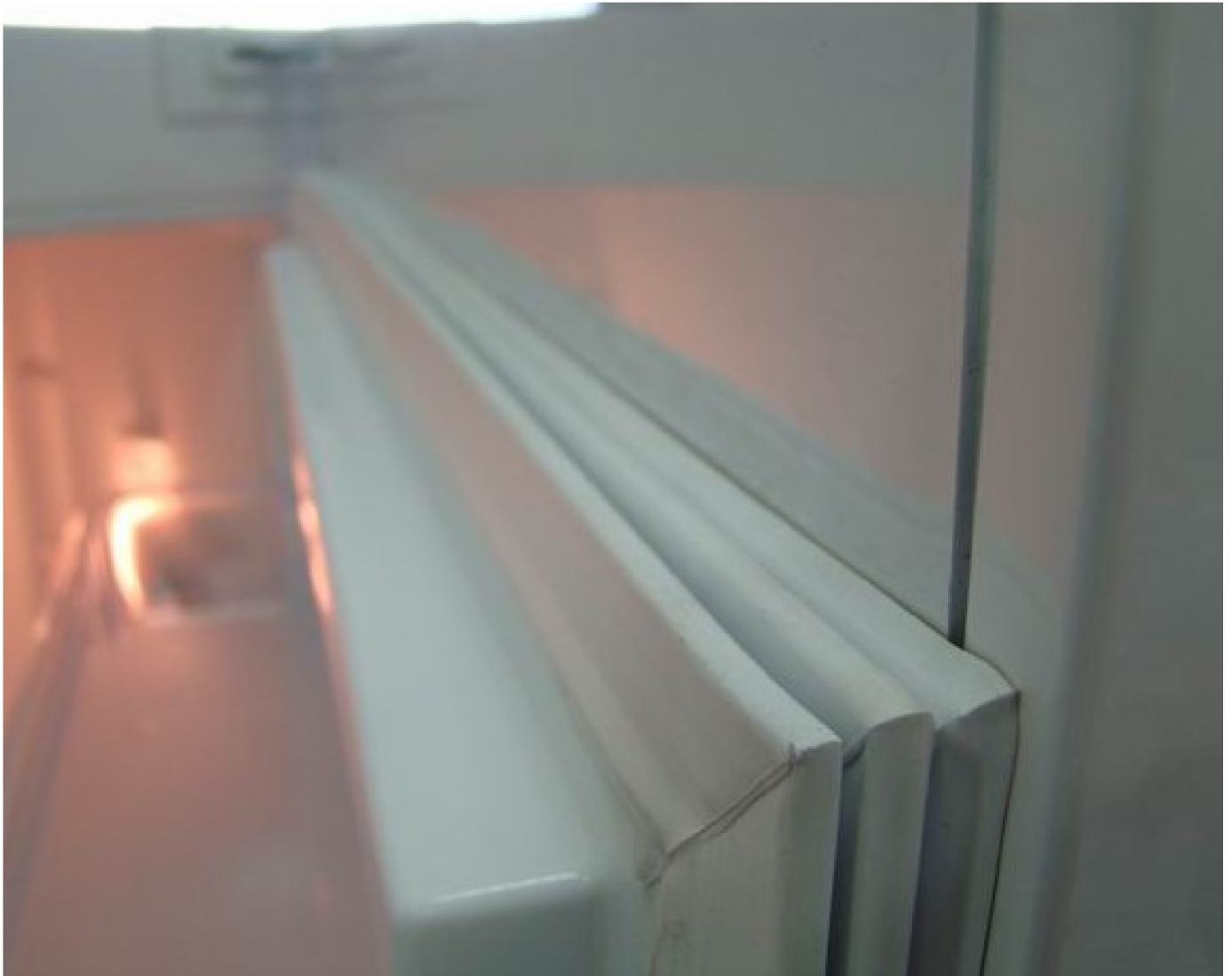

## Service Bulletin 4812 711 40338

**AUTHOR:** Robert Zimmermann

**Last Update:** 06/17/10

**VERSION:** 1.0

**TITLE:** Pipes vibration in the compressor niche.

**SUBJECT:** In some cases the vibrations from compressor induce vibrations of pipes in the niche. Typically, it concerns to the discharge tube. As an effect a audible noise is generated by the tube.

### REMEDIAL ACTION

To reduce the noise a damper should be applied. Therefore a kit was created with the order number 4801 321 02827. The kit consist of 3 damper. The availability date of the kit in SPC is week 11/2010.

The damper will not be implemented in production, but the positioning of the pipes will be improved in order to eliminate the vibrations.

Please follow the below repair instruction.

## **Repair Instruction**

By pressing the pipe with the fingers (hand), you can find out from which pipe the vibration is generated. By pressing with the fingers, it will reduce the pipe vibration noise.

This is the indication for the correct position to place the damper.

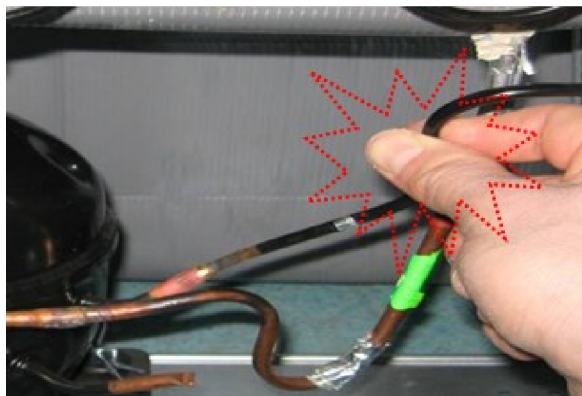

To reduce the noise a damper should be applied as show in the picture below.

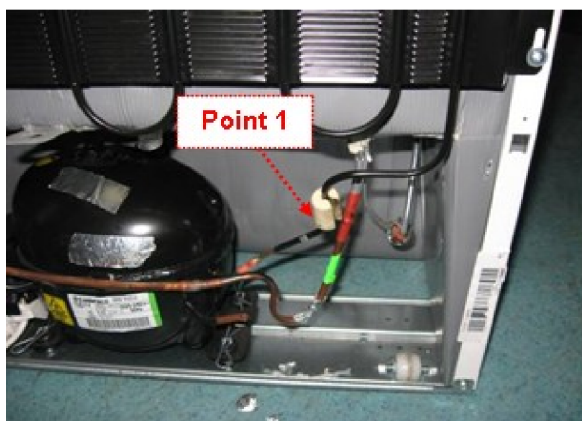

There are also other points (2 & 3) along the pipe where the damper can be applied.

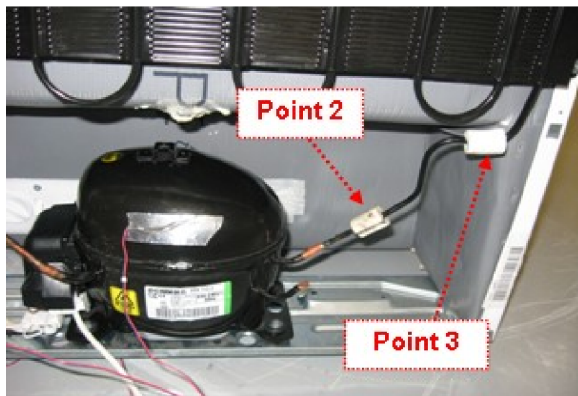

## Service Bulletin 4812 711 40310

**AUTHOR:** Robert Zimmermann

**Last Update:** 09/19/08

**VERSION:** 1.0

**TITLE:** Running change of capillary tube in production.

### CAUSE

due to the fact that the Whirlpool cooling factories will implement step by step the running change from copper capillary tube into aluminum capillary tube, it is necessary for a service intervention to use the correct LOKRING connector. The relevant connection point is on the filter dryer to the capillary tube. The conclusion is valid for both refrigerants, R134a and R600a.

The order number for the LOKRING connector 5/1,8NR MS 00 is: 4801 331 00001