

Moulinex
uno

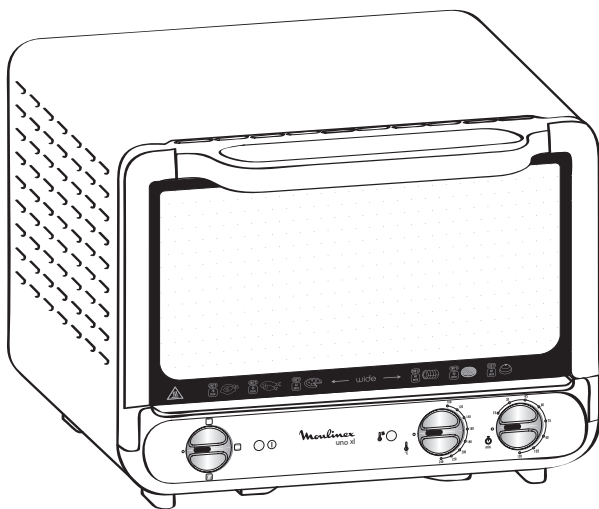

FR

EN

DE

NL

IT

ES

PT

EL

AR

FA

www.moulinex.com

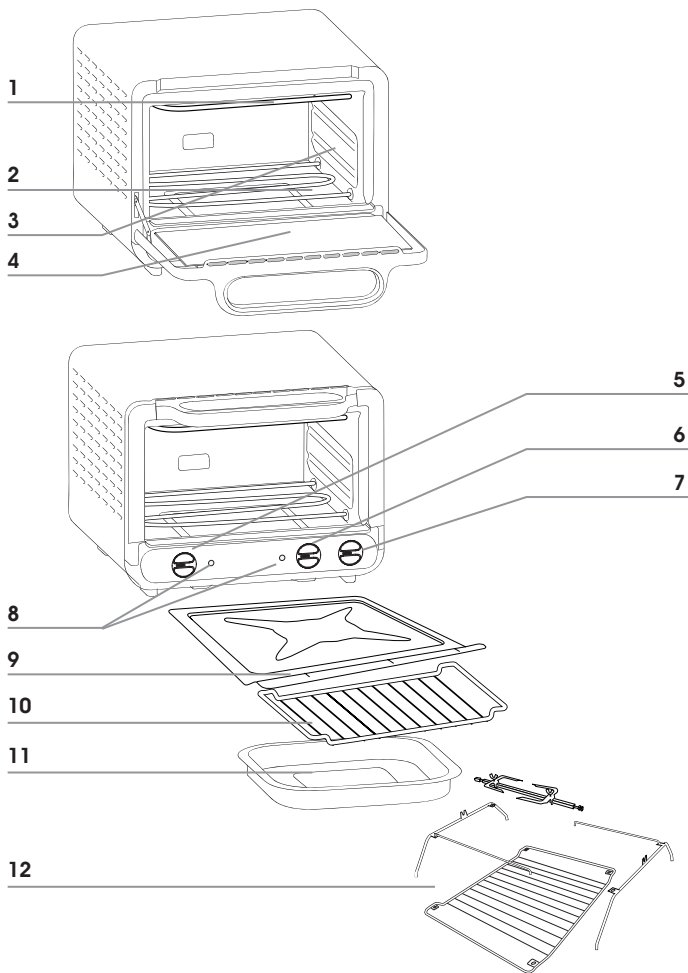

* Selon modèle - depending on model - Je nach Modell - afhankelijk van het model -
 secondo il modello - según modelo - Consoante os modelos - ανάλογα με το μοντέλο

DESCRIPTION

1. Résistance supérieure
2. Résistance inférieure
3. Parois non stick
4. Porte double parois
5. Bouton des fonctions
6. Bouton de réglage température
7. Bouton de minuterie
8. Voyants de fonctionnement
9. Sole ramasse miettes
10. Grille réversible
11. Plat non adhésif
12. Kit tournebroche (1 grille, 2 fourches, 2 supports broche, 1 tige, 1 plat)

DESCRIPTION

1. Top heating element
2. Bottom heating element
3. Non-stick walls
4. Double-wall door
5. Function buttons
6. Temperature control button
7. Timer button
8. Power indicator lights
9. Crumb tray
10. Reversible shelf
11. Non-stick oven tray
12. Rotisserie kit (1 grill, 2 forks, 2 meat holders, 1 spit rod, 1 plate)

BESCHREIBUNG

1. Oberes Heizelement
2. Unteres Heizelement
3. Antihaffbeschichtete Wände
4. Doppelwandige Tür
5. Funktionsknöpfe
6. Temperaturregler
7. Timer-Knopf
8. Betriebsleuchten
9. Krümelblech
10. Umkehrbarer Rost
11. Antihaffbeschichtete Backform
12. Drehspieß-Set (1 Rost, 2 Gabeln, 2 Spießhalterungen, 1 Spieß, 1 Schale)

BESCHRIJVING

1. Bovenste verwarmingselement
2. Onderste verwarmingselement
3. Anti-aanbakwanden
4. Dubbelwandige deur
5. Functieknoppen
6. Temperatuurregelknop
7. Timerknop
8. Aan/uit-controlelampjes
9. Kruimellade
10. Omkeerbaar rooster
11. Anti-aanbakovenschaal
12. Draaispijset (1 rooster, 2 vorken, 2 spithouders, 1 stang, 1 schaal)

DESCRIPCIÓN

1. Resistencia superior
2. Resistencia inferior
3. Paredes antiadherentes
4. Puerta de doble cristal
5. Botones de funciones
6. Botón de ajuste de temperatura
7. Botón de temporizador
8. Pilotos de funcionamiento
9. Bandeja recogemigas
10. Rejilla reversible
11. Fuente antiadherente
12. Kit de asador (1 rejilla, 2 tenedores, 2 soportes para brocheta, 1 vainilla, 1 fuente)

DESCRIPTION

1. Resistência superior
2. Resistência inferior
3. Paredes antiaderentes
4. Porta de parede dupla
5. Botões das funções
6. Botão de regulação da temperatura
7. Botão temporizador
8. Indicadores de funcionamento
9. Bandeja para migalhas
10. Grelha reversível
11. Prato não aderente
12. Kit espeto rotativo (1 grelha, 2 forquilhas, 2 suportes para espeto, 1 haste, 1 prato)

DESCRIZIONE

1. Resistenza superiore
2. Resistenza inferiore
3. Pareti anti-adesive
4. Sportello a parete doppia
5. Pulsanti delle funzioni
6. Manopola di regolazione della temperatura
7. Manopola del timer
8. Spie di funzionamento
9. Fondo raccogli-briciole
10. Griglia reversibile
11. Piatto non adesivo
12. Kit girarrosto (1 griglia, 2 forcelle, 2 supporti per spiedo, 1 asta, 1 piatto)

περιγραφή

1. Αντίσταση στο επάνω μέρος
2. Αντίσταση στο κάτω μέρος
3. Αντικολλητικοί τοίχοι
4. Διπλής αντοχής πόρτα
5. Κουμπιά λειτουργιών
6. Κουμπιά θερμοκρασίας
7. Χρονόμετρο
8. Φωτεινή ένδειξη λειτουργίας
9. Ψυχουλοσυλλέκτης
10. Ράφι διπλής όψης
11. Αντικολλητικός δίσκος
12. Kit περιστρεφόμενης σούβλας (1 εσχάρα, 2 διχάλες, 2 στηρίγματα σούβλας, 1 σούβλα, 1 ταψί)

الوصف

1. مقاومة أعلى
2. مقاومة أدنى
3. جدار غير لاصق
4. باب بجدار مزدوج
5. زر التشغيل
6. زر تعديل الحرارة
7. زر التوقيت
8. أضواء التشغيل
9. أرضية لجمع الفتات
10. شواية تعمل بالاتجاهين
11. طبق مقاوم للاصق
12. عدة الشواية (1 قلاية، 2 شوكة، 2 دعامة لسبخ الشواء، 1 ذراع، 1 طبق

- شرح
1. استحکام عالی
 2. مقاومت کمتر
 3. دیواره نجسب
 4. دیواره دو جداره
 5. دکمه انتخاب عملکردها
 6. دکمه تنظیم دما
 7. دکمه زمان سنج
 8. نشانگرهای عملکرد
 9. دارای اشغال جمع کن
 10. توری برگشت پذیر
 11. سطح نجسب
 12. کیت کباب/بریان کردن (1 عدد توری، 2 عدد چنگال، 2 عدد گیره نگهدارنده، 1 عدد میله گردان، 1 عدد بشقاب

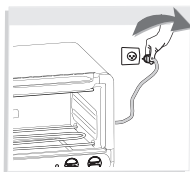
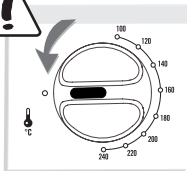
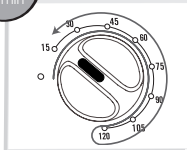
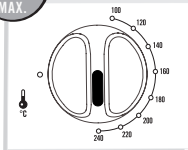
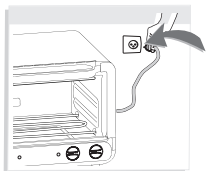
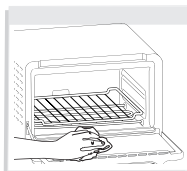
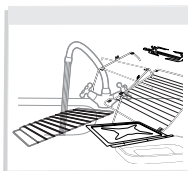
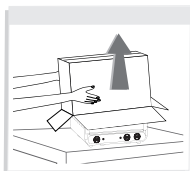
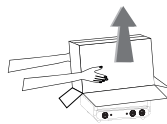

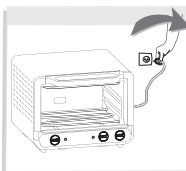
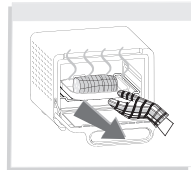
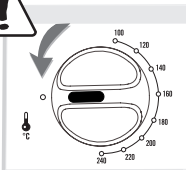
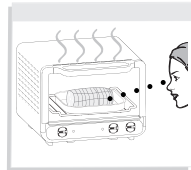
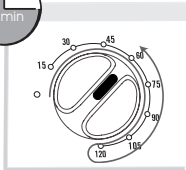
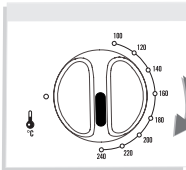
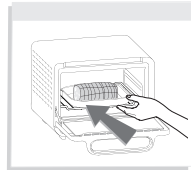
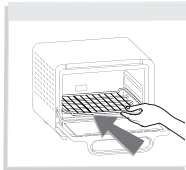
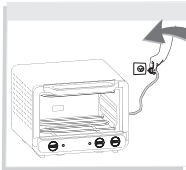

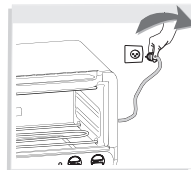
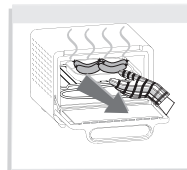
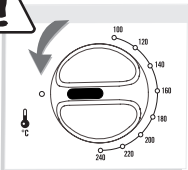
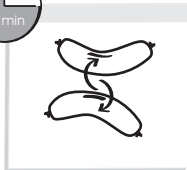
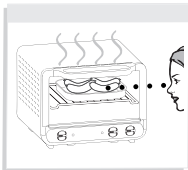
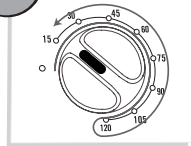
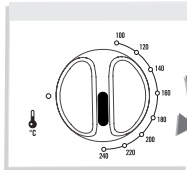
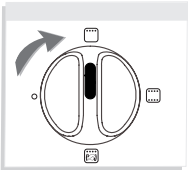
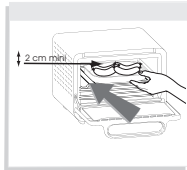
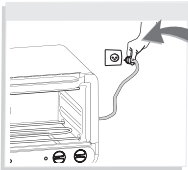

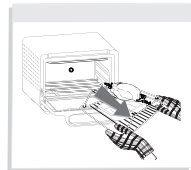
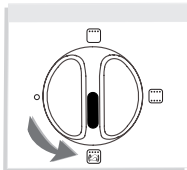
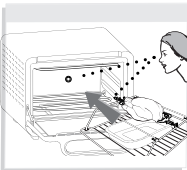
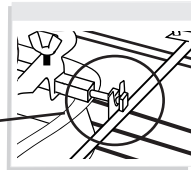
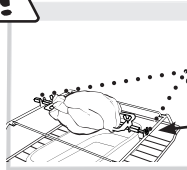
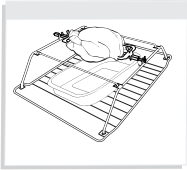
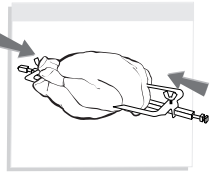
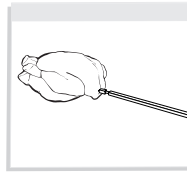
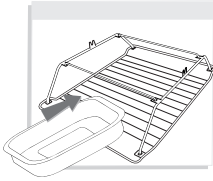
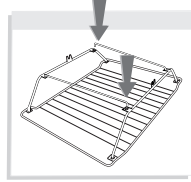
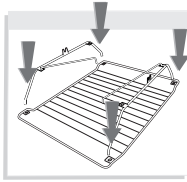

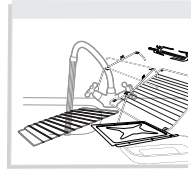
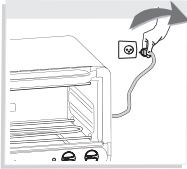



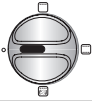
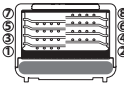







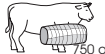

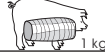

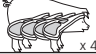











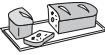



			 °C	Préchauffage Preheat	 min.
		4	240	10 min	20 min
 1,5 kg		3	220	-	70 min
		-	-	-	80 min
 750 g		4	240	10 min	20 min
 1 kg		5	240	-	80 min
 x 4		7	-	10 min	20 + 10 min
 x 9		7	-	-	8 + 13 min
		4	210	-	30 min
		2	210	10 min	65 min
		3	220	10 min	25 min
		4	240	-	25 min
		3	180	10 min	50 min
		4	180	10 min	30 min

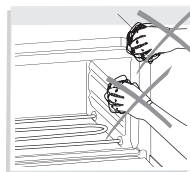
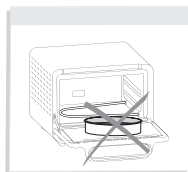
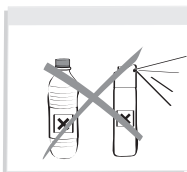
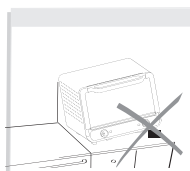
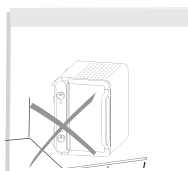
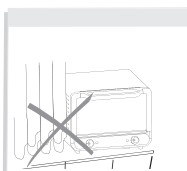
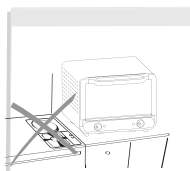
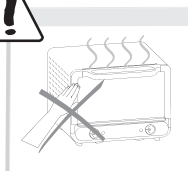
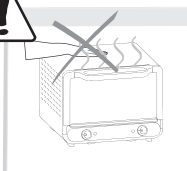
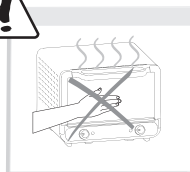
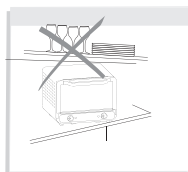
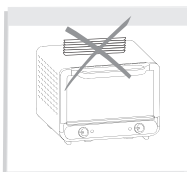

 : www.moulinex.com

			
ALGERIA	GRUPE SEB EXPORT Chemin du Petit Bois, Les 4M 69130 ECULLY - FRANCE	213-41-28-18-53	1 year
ARGENTINA	GRUPE SEB ARGENTINA S.A. Billinghurst 1833 3° C1425DTK Capital Federal Buenos Aires	0800-122-2732	2 años
ՀԱՅԱՍՏԱՆ ARMENIA	«Գրուպա ՄԵԲ-Վուստոկ»ՓԲԸ, 119180 Մոսկվա, Ռուսաստան Ստարոմոնետնի կրք., ս.14, շ.2	(010) 55-76-07	2 տարի/ years
AUSTRALIA	GRUPE SEB AUSTRALIA PO Box 7535, Silverwater NSW 2128	02 97487944	1 year
ÖSTERREICH	SEB ÖSTERREICH HmbH Campus 21 - Businesspark Wien Süd Liebermannstr. A02 702 2345 Brunn am Gebirge	01 866 70 299 00	2 Jahre
BELGIQUE / BELGIE	GRUPE SEB BELGIUM SA NV 25 avenue de l'Espérance - ZI 6220 Fleurus	32 70 23 31 59	2 ans / years
БЕЛАРУСЬ / BELARUS	ЗАО «Група СЕБ-Востока», 119180 Москва, Россия Старомонетный пер. д.14 стр.2	017 2239290	2 года/ years
BOSNA I HERCEGOVINA	SEB Développement Predstavništvo u BiH Vrazova 8/II 71000 Sarajevo	Info-linija za potrošače 033 551 220	2 godine
BRASIL	GRUPO SEB DO BRASIL PRODUTOS DOMESTICOS LTDA Avenida Arno, 146 Mooca 03108-900 São Paulo SP	0800-119933	1 ano
БЪЛГАРИЯ/ BULGARIA	ГРУП СЕБ БЪЛГАРИЯ ЕООД Ул. Борова 52 Г, ет. 1, офис 1, 1880 София	0700 10 330	2 години
CANADA	GRUPE SEB CANADA 345 Passmore Avenue Toronto, ON M1V 3N8	1-800-418-3325	1 year
CHILE	GRUPE SEB CHILE Comercial Ltda Avda. Nueva Los Leones 0252 Providencia, Santiago	+56 2 232 77 22	2 años
COLOMBIA	GRUPE SEB COLOMBIA Apartado Aereo 172, Kilometro 1 Via Zipaquirá Cajica Cundinamarca	18000919288	2 años
HRVATSKA Croatia	SEB Développement S.A.S. Vodnjanska 26 10000 Zagreb	01 30 15 294	2 godine
ČESKÁ REPUBLIK / CZECH REPUBLIC	GRUPE SEB CR spol. s r. o. Jankovcova 1569/2c 170 00 Praha 7	731 010 111	2 roky
DANMARK	GRUPE SEB NORDIC AS Tempovej 27 2750 Ballerup	44 663 155	2 år
DEUTSCHLAND	GRUPE SEB DEUTSCHLAND GmbH / KRUPS GmbH Herrrainweg 5 63067 Offenbach	0212 387 400	2 Jahre





 : www.moulinex.com

			
EESTI/ ESTONIA	GRUPE SEB POLSKA SP Z O.O. ul. Ostrobramska 79 04-175 Warszawa	5 800 3777	2 aastat
SUOMI / FINLAND	Grupe SEB Finland Kutojantie 7 02630 Espoo	09 622 94 20	2 Vuotta
FRANCE Inclus Martinique, Guadeloupe, Réunion & St. Martin	GRUPE SEB France SAS Place Ambroise Courtois 69355 Lyon Cedex 08	09 74 50 10 14	1 an
GREECE / ΒΛΛΑΔΑ	SEB GROUPE ΕΛΛΑΔΟΣ Α.Ε. Οδός Φραγκοκλησιάς 7 Τ.Κ. 151 25 Παράδεισος Αμαρουσίου SEB ASIA Ltd.	2106371251	2 Χρόνια
HONG KONG	Room 901, 9/F, North Block, Skyway House 3 Sham Mong Road, Tai Kok Tsui, Kowloon	852 8130 8998	1 year
MAGYARORSZÁG/ Hungary	GRUPE SEB CENTRAL-EUROPE Kft. Tavíro köz 4 2040 Budaörs	(1) 8018434	2 év
INDONESIA	Grupe SEB Indonesia (Representative office) Sudirman Plaza, Plaza Marein 8th Floor JL Jendral Sudirman Kav 76-78, Jakarta 12910, Indonesia	+62 21 5793 6881	1 year
ITALIA	GRUPE SEB ITALIA S.p.A. Via Montefeltro, 4 20156 Milano	1 99 207 892	2 anni
JAPAN	GRUPE SEB JAPAN Co. Ltd. 1F Takanawa Muse Building, 3-14-13, Higashi Gotanda, Shinagawa-Ku, Tokyo 141-0022	0570-077772	1 year
ҚАЗАҚСТАН KAZAKHSTAN	«Группа СЕБ-Восток» ЖАҚ, 119180 Мәскеу, Ресей Старомонетный түйік көш, 14-үй, 2-жұрылыс	727 378 39 39	2 жыл / years
KOREA	(유)그룹 세브 코리아 서울시 종로구 서린동 88 서린빌딩 3 층 110-790	1588-1588	1 year
LATVJA / LATVIA	GRUPE SEB POLSKA SP Z O.O. ul. Ostrobramska 79 04-175 Warszawa	6 716 2007	2 gadi
LIETUVA/ LITHUANIA	GRUPE SEB POLSKA SP Z O.O. ul. Ostrobramska 79 04-175 Warszawa	6 470 8888	2 metai
MACEDONIA	Grupe SEB Bulgaria EOOD Office 1, floor 1, 52G Borovo St., 1680 Sofia - Bulgana ГРУП СЕБ БЪЛГАРИЯ ДООЕЛ Ул. Борово 52 Г, сп. 1, офис 1, 1680 София, България	(0)2 20 50 022	2 години / years
MALAYSIA	GRUPE SEB MALAYSIA SDN. BHD Lot No. C/3A/001 & 002, Block C, Kelana Sq. No.17, Jalan S37/26, 47301 Kelana Jaya Petaling Jaya, Selangor	65 6550 8900	1 year
MEXICO	G.S.E.B. MEXICANA, S.A. de C.V. Goldsmith 38 Desp. 401, Col. Polanco Delegacion Miguel Hidalgo 11 560 Mexico D.F.	(01800) 112 8325	1 años

 : www.moulinex.com

			
MOLDOVA	TOB «Грун СЕБ Україна» Вул. Драгоманова 31 Б, офіс 1 02068 Київ, Україна	(22) 929249	2 ani / years
NEDERLAND	GGROUPE SEB NEDERLAND BV Generatorstraat 6 3903 LJ Veenendaal	0318 58 24 24	2 jaar
NEW ZEALAND	GROUPE SEB NEW ZEALAND Unit E, Building 3, 195 Main Highway, Ellerslie, Auckland	0800 700 711	1 year
NORGE	GROUPE SEB NORDIC AS Tempovej 27 2750 Ballerup DANMARK	815 09 567	2 år
PERU	GROUPE SEB COLOMBIA Av. Camino Real N° 111 of. 805 B San Isidro - Lima - Perú	+511 441 4455	1 años
POLSKA/ POLAND	GROUPE SEB POLSKA SP Z O.O. ul. Ostrobramska 79 04-175 Warszawa	0 801 300 423 koszt jak za połączenie lokalne	2 lata
PORTUGAL	GROUPE SEB IBÉRICA SA Urb. da Malinha Rua Projectada à Rua 3 Bloco1 - 3° B/D 1900 - 796 Lisboa	808 284 735	2 anos
REPUBLIC OF IRELAND	GROUPE SEB IRELAND Unit B3 Aerodrome Business Park, College Road, Rathcoole, Co. Dublin	01 677 4003	1 year
ROMÂNIA/ ROMANIA	GROUPE SEB ROMÂNIA Str. Daniel Constantin nr. 8 010632 București	0 21 316 87 84	2 ani
РОССИЯ/ RUSSIA	ЗАО «Группа СЕБ-Восток», 119180 Москва, Россия Старомонетный пер. д.14 стр.2	495 213 32 29	2 года/ years
SRBIJA Serbia	SEB Développement Antifasisticke borbe 17/13 11070 Novi Beograd	060 0 732 000	2 godine
SINGAPORE	GROUPE SEB SINGAPORE Pty Ltd. 59 Jalan Pemimpin, #04-01/02 L&Y Building Singapore 577218	65 6550 8900	1 year
SLOVENSKO/ SLOVAKIA	GROUPE SEB SLOVENSKO s.r.o. Rybničná 40 831 07 Bratislava	233 595 224	2 roky
SLOVENIJA	SEB d.o.o Gregorčičeva ulica 6 2000 MARIBOR	02 234 94 90	2 leti
ESPAÑA	GROUPE SEB IBÉRICA S.A. Almogüers, 119-123, Complejo Ecourban 08018 Barcelona	0902 31 22 00	2 años
SVERIGE	TEFAL SVERIGE SUBSIDIARY OF GROUP SEB NORDIC Truckvägen 14 A, 194 52 Upplands Väsby	08 594 213 30	2 år
SUISSE SCHWEIZ	GROUPE SEB SCHWEIZ GmbH Thurgauerstrasse 105 8152 Glatthbrugg	044 837 18 40	2 ans / Jahre
TAIWAN	SEB ASIA Ltd. Taipei International Building, Suite B2, 6F-1, No. 216, Tun Hwa South Road, Sec. 2 Da-an District Taipei 106, R.O.C.	886-2-27333716	1 year

 : www.moulinex.com

			
THAILAND	<p>GROUPE SEB THAILAND 2034/66 Italthai Tower, 14th Floor, n° 14-02, New Phetchburi Road, Bangkok, Huaykwang, Bangkok, 10320</p>	02723 4488	2 years
TÜRKIYE	<p>GROUPE SEB ISTANBUL AS Beybi Giz Plaza Dereboyu Cad. Meydan Sok. No: 28 K.12 Maslak</p>	216 444 40 50	2 YIL
U.S.A.	<p>GROUPE SEB USA 2121 Eden Road Millville, NJ 08332</p>	800-395-8325	1 year
Україна/ UKRAINE	<p>ТОВ «Грун СЕБ Україна» Вул. Драгоманова 31 Б, офіс 1 02068 Київ, Україна</p>	044 492 06 59	2 роки/ years
UNITED KINGDOM	<p>GROUPE SEB UK Ltd. 11-49 Station Road Langley, Slough Berkshire SL3 8 DR</p>	0845 602 1454	1 year
VENEZUELA	<p>GROUPE SEB VENEZUELA Av Eugenio Mendoza, Centro Letonia, Torre ING Bank, Piso 15, Ofc 155 Urb. La Castellana, Caracas</p>	0800-7268724	2 anno
VIETNAM	<p>GROUPE SEB VIETNAM (Representative office) 127-129 Nguyen Hue Street District 1, Ho Chi Minh City, Vietnam</p>	+84-8 3821 6395	1 year

